

T27 FORCE

Agglomerated cork underlayment for impact noise and thermal insulation

PRODUCT SPECIFICATION

Resilient acoustic underlayment made of agglomerated cork with PU (polyurethane) elastomer bonding agent for impact noise insulation for ceramic or natural stone tiles, with a density up to 220kg/m³.

KEY FEATURES

- ▶ Natural material
- ▶ High acoustic insulation
- ▶ Ceramic crack suppression
- ▶ High thermal insulation
- ▶ Walking comfort

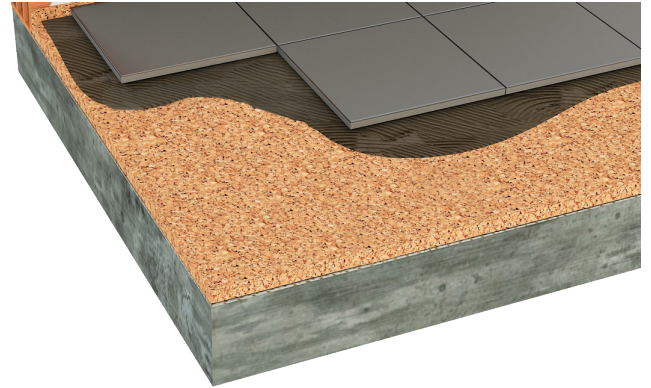

PHYSICAL AND MECHANICAL PROPERTIES

Specific Weight (kg/m ³ lb/ft ³) ①	160-220 10-14
Tensile Strength (kPa) ①	> 400
Compression at 0.7MPa (%) ①	25-40
Recovery after 0.7MPa (%) ①	> 75

① ISO 7322

TECHNICAL PROPERTIES

Flooring		Ceramic/Natural Stone
Thickness	mm	12.7
Thermal Resistance (TR) ①	m ² .°C/W	0.261
Floor Durability		
Punctual Conformability (PC) ①	mm	NA
Compressive Strength (CS) ①	kPa	NA
Compressive Creep (CC) ①	kPa	—
Water Vapor Resistance (SD) ①	m	NA
Vapor Barrier		○

① EN 16354 TBD To be determined NA Not applicable ● Yes ○ No

ACOUSTIC RESULTS

Flooring		Ceramic
Flooring Thickness	mm	10
Underlayment Thickness	mm	12.7
Impact Insulation (IS) ^①	dB (ISO)	—
Impact Insulation IIC Δ IIC ^②	dB (ASTM)	78 —
Sound Transmission (STC) ^③	dB (ASTM)	74
System (Glued Floating)		Glued
System (Ceiling)		●

① Standard ISO 717-2:2013 ② Standard ASTM E413 ③ Standard ASTM E989-89 ● Yes ○ No

Impact Insulation Class (IIC) · Ceramic Floor (10mm)
· T27 (12.7mm) · Glued

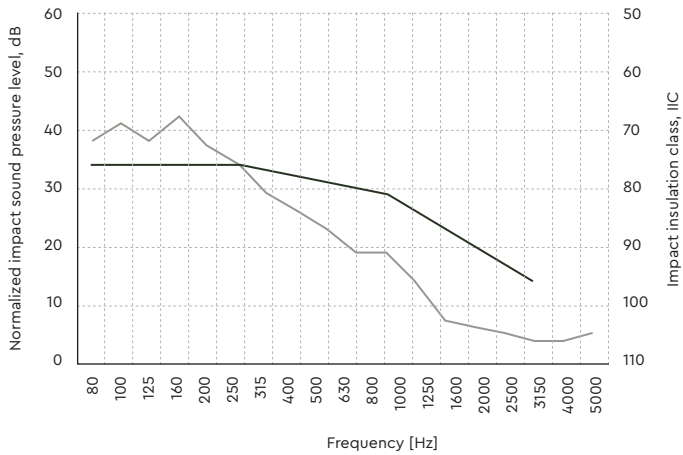

— L_n (dB) — Adjusted refer curve (dB)

Sound Transmission Class (STC) · Ceramic Floor (10mm)
· T27 (12.7mm) · Glued

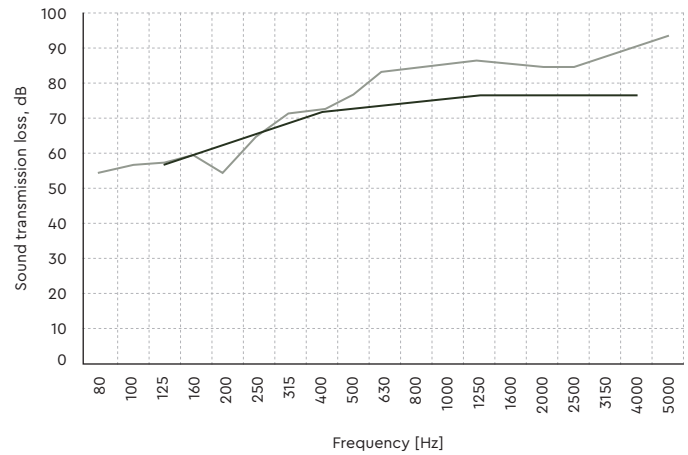

— $L_{n,r0}$ (dB) — Adjusted refer curve (dB)

TEST APPARATUS (ΔL_w)

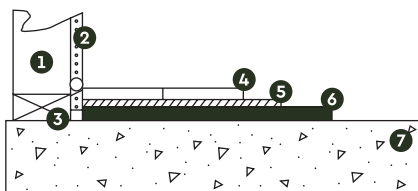

- 1 Wall
- 2 Wall board
- 3 Perimeter isolation barrier (optional)
- 4 Ceramic tile or natural stone
- 5 Adhesive (recommended flooring producer)
- 6 Acousticork T27
- 7 Adhesive (recommended flooring producer)
- 8 Subfloor concrete slab

INSTALLATION

GLUED FLOORS

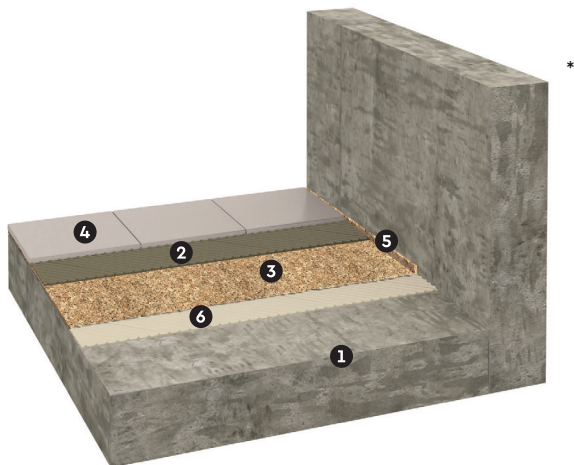

- 1 Reinforced concrete slab
- 2 Cement glue
- 3 Agglomerated cork resilient layer – Acousticork T27
- 4 Floor covering composed by glued down wood, ceramic or nature stone
- 5 Perimeter insulation barrier (optional)
- 6 Adhesive (optional)

*Product images and illustrations are for illustrative purposes only.

GENERAL INSTALLATION INSTRUCTIONS

The following installation instructions are recommended by Amorim Cork Composites, but are not intended as a definitive project specification. They are presented in an attempt to be used with recommended installation procedures of the flooring installer.

Final Flooring

Always follow manufacturers recommended installation instructions, particularly when adhesives are recommended.

Recommended Adhesives

Ceramic to Acousticork: Flexible Cement Glue.

Important Notes

Never mechanically fasten the Acousticork T27 to the flooring floor as this will severely diminish its acoustical value.

For more detailed installation instructions, please contact us.

APPLICATION PROCESS · GLUED FLOOR

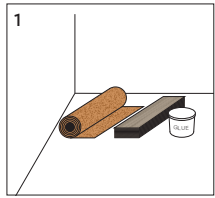

These are all the materials needed to install the underlayment.

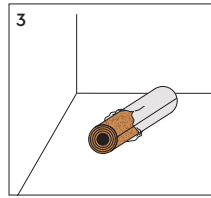
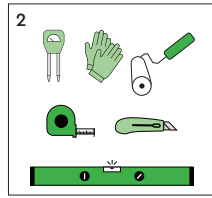

For the installation process, open the packaging 48 hours in advance and leave for acclimatization

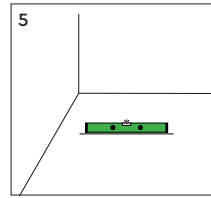
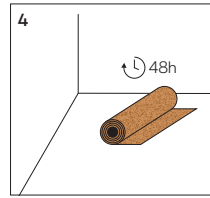

Subfloor preparation: Make sure that the subfloor is leveled, dry, clean and in good structural conditions.

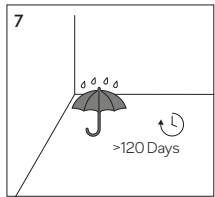
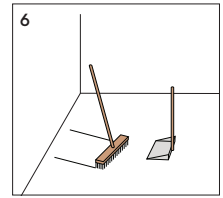

New concrete slabs must be left to cure for 120 days before installation.

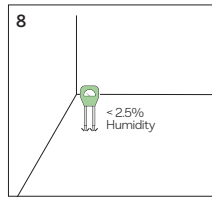

The humidity content of the substrate is critical: it must not exceed 2.5% (MC).

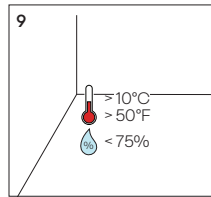

Air temperature should be above 10°C and air humidity below 75%.

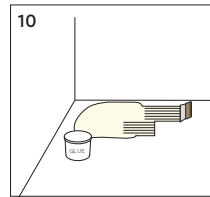

Optional step: apply the glue using a trowel. The installation of a moisture barrier is not necessary.

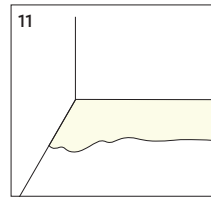

Optional step: we recommend the use of an adequate glue for the flooring to be installed.

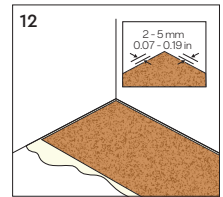

Install the underlayment directly on the adhesive, leave a space between the wall and the underlayment.

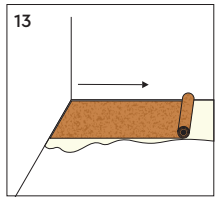

The underlayment should be installed in a perpendicular direction that you plan to install the final floor.

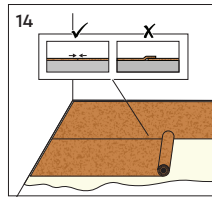

The underlay must cover the entire area without any gaps nor overlaps.

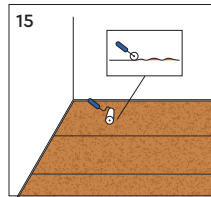

Use the paint roller to make sure the underlayment doesn't have any waves.

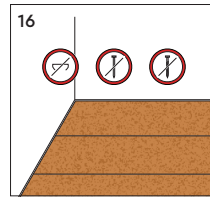

Never mechanically secure the underlayment with screws, nails or staples, since this may undermine its effectiveness.

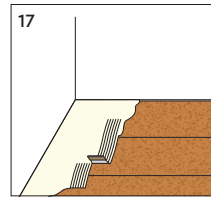

Apply the same glue on the underlayment.

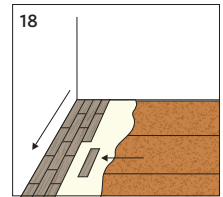

Install the flooring in a perpendicular direction to the underlayment, and let the whole floor dry completely before you start to use it.

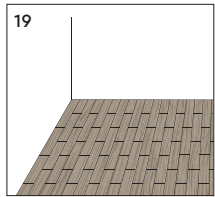

Always follow the flooring manufacturer's recommended installation instructions.

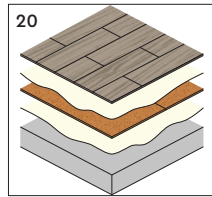

Total System.



For more information about this installation process and for non glued floors, access here

TECHNICAL DATA SHEET T27 FORCE

The data provided in this Technical Data Sheet represents typical values. This information is not intended to be used as a purchasing specification and does not imply suitability for use in a specific application. Failure to select the proper product may result in either equipments damage or personal injury. Please contact Amorim Cork Composites regarding specific application recommendations. Amorim Cork Composites expressly disclaims all warranties, including any implied warranties or merchantability or of fitness for a particular purpose. Amorim Cork Composites is not liable for any indirect special, incidental, consequential, or punitive damages as a result of using the information listed in this TDS. Any of its material specification sheets, its products or any future use or re-use of them by any person or entity. For contractual purposes, please request our Product Specifications Sheet (PDA).